

TRACE

LSTP05M-CC

3" horizontal recessed step light



PROJECT

DATE

TYPE

QTY

NOTES

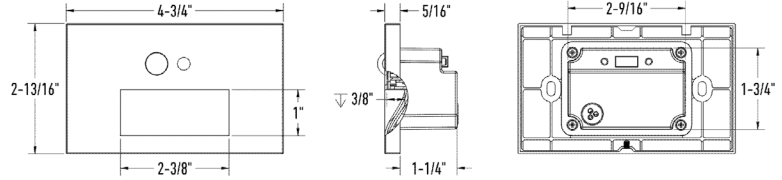

LIGHT DISTRIBUTION

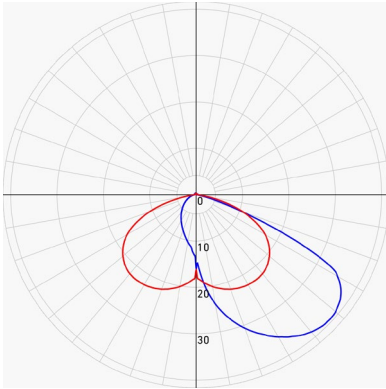

Distance from luminaire	FC at Nadir	Diameter
2'	4.0 fc	13'-1"
3'	1.8 fc	19'-8"
4'	1.0 fc	26'-2"
5'	0.6 fc	32'-9"
6'	0.4 fc	39'-3"

*measured at 3000k

SPECS

Watts (W)	3	
Delivered lumens*	85	
Voltage (v)	120	
CRI	96	
TM-30	Rf : 92	Rg : 103
Binning	1 SDCM	
Beam angle (deg)	84	
UGR	-	
LED model	2835	
Light direction	Down	
Dimming	Not dimmable	
Mounting	2x3 Jbox	
Color temperature	2200k/2700k/3000k/3500k/4000k	

CONSTRUCTION

Lens material	Polystyrene
Optic type	Frosted

ELECTRICAL DETAILS

Location	Wet	
Environment	Indoor/Outdoor	
Operating temp. (° C)	-20	to 45
IP rating	IP65	
Input current (mA)	30	
Output voltage (V)	15	
Output current (mA)	140	
Power factor (%)	50	
Driver type	Class 2	
THD	-	
Lifetime @ L70	-	
BUG rating	B0-U1-G0	

Finish type	Powder coated
Housing material	Aluminum

ORDERING GUIDE

LSTP05M-CC	-	Finish
WH	-	White <input type="checkbox"/>
BK	-	Black <input checked="" type="checkbox"/>

CERTIFICATIONS

ETL listed	UL-1598	and	CSA C22.2 No. 250.0
Compliant to	FCC Title 47 Part 15; Class B		
	ICES-005 Issue 5		



CANADA
80, Blvd. de la Seigneurie E.
Blainville, Quebec J7C 4N1

USA
4383, NW 124th Ave.,
Coral Springs, Florida 33065

1 877.430.1818
info@dals.com
dals.com

WHAT'S IN THE BOX

LED flush mount fixture
Mounting bracket
Mounting hardware
Wire nuts
Instruction sheet

ACCESSORIES**ADAPTORS****WARRANTY**

DALS offers a 5-year warranty from the date of purchase which covers repairs or replacement of defective parts of the housing, optics, and electronics. To contact DAL'S customer service call 1-877-430-1818 or send an e-mail to info@dals.com.



