

NATA NATAI

LED . INDIRECT



- Standard Natatorium Powder coat paint finish exceeding 5,000 salt spray hours
- IP65 Rated Luminaire to protect luminaire in harsh corrosive environment
- High Lumen output asymmetric distribution to achieve IES 30 FC code for illuminating pool surfaces

5 YEAR
WARRANTY

PART #:	
PREP BY:	DATE:
PROJECT:	QTY:
NOTES:	
APPROVAL SIGNATURE:	DATE (DD/MM/YYYY):

PERFORMANCE SUMMARY
at 4000K

LIGHT LEVEL L2

Lumens	25685
Wattage	230
Efficacy	111
Color Rendering (CRI) ¹	80+
L70 Estimate (h)	> 60,000 hrs

¹ For CRI 90, please refer to Lumen Adjustment Factor chart below.

OTHER PRODUCTS FOR NATATORIUMS:

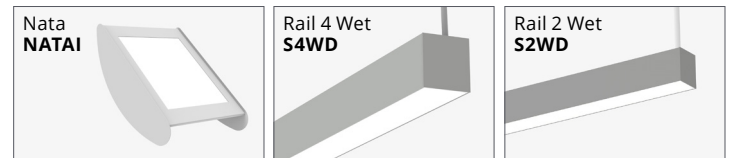
ORDERING STEPS: 1. Complete **ORDERING LOGIC**. 2. Complete **MOUNTING KITS** on page 2.

1. ORDERING LOGIC

Example Part Number: NATAI-18L40K-NC-NW-L21-4-R-90

QTY	NATA I Series	1	2	3	4	5	6	7	8	9	10	11	12
1. MODEL / SIZE	2. COLOR TEMP	3. OPTICS UP	4. OPTICS DOWN	5. FINISH	6. LIGHT LEVEL / DRIVER	7. CIRCUITRY	8. MOUNTING	9. VOLTAGE	10. CONTROLS	11. DRIVER LOCATION	12. OPTIONS		
I Indirect Only	18L40K 4000K	NC Nata Clear Lens	— None (leave space empty)	NW Natatorium White NC Natatorium Custom Specify RAL:	L1 L2 L3 L2 & L3 drivers are remote. Refer to "LIGHT LEVEL PERFORMANCE & PHOTOMETRICS" chart below	1 1 Circuit	Select Mounting Kit in STEP 2.	3 347 V 4 UNV (120 - 277V)	— None (leave space empty)	I Integral R Remote	90 90 CRI, High R9 PI Pure Indirect — None (leave space empty)	LX Custom range. Specify lumens: (Total lumens between 15700-39800 at 500 lm intervals)	
Fixture includes mounting bracket to adapt NATAI to existing AW7 arms. See page 4 for more info.													

LIGHT LEVEL PERFORMANCE & PHOTOMETRICS

4000K, 80CRI, 0-10V Dimming (Standard)

	Light Level	Lumens	Wattage	Efficacy (LPW)	IES File	Distribution % (Down / Up)	Zonal Lumens (0-90 / 90-180)	Distribution Curve
Standard Mount	L1	15734	129	122	NATAI-18L40K-NC-L1	10 / 90	1573 / 14161	
	L2	25685	230	111	NATAI-18L40K-NC-L2		2568 / 23117	
	L3	39800	394	101	NATAI-18L40K-NC-L3		3980 / 35820	
Pure Indirect	L1	15734	129	122	NATAI-18L40K-NC-L1-PI	0 / 100	0 / 15734	
	L2	25685	230	111	NATAI-18L40K-NC-L2-PI		0 / 25685	
	L3	39800	394	101	NATAI-18L40K-NC-L3-PI		0 / 39800	

Metalumen's light level performance metrics are subject to manufacturers component tolerances.

2. MOUNTING KITS

Wall Mount

	NATA		
QTY	SW Single Wall DW Double Wall	I Integral R Remote	Finish*

Pendant Mount

	NATA			
QTY	SA Single Arm DA Double Arm	I Integral R Remote	Indicate arm length (max 5ft**)	Finish*

Pendant Mount Back-to-back

	NATA			
QTY	SB Single Arm DB Double Arm	I Integral R Remote	Indicate arm length (max 5ft**)	Finish*

*Finish

NW	Natatorium White
NC	Natatorium Custom Specify RAL# _____

** Maximum length from ceiling surface to top of fixture.
Custom lengths available upon request.

Custom Slope Pendant

Consult Factory

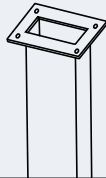

Code	Mounting Kit	NATADI
SW Single Wall	Single wall mount included. Specify appropriate mounting kit for all other applications (Driver location is selected in Ordering Logic on page 1)	
DW Double Wall		
SA Single Arm Pendant		
DA Double Arm Pendant		
SB Single Arm Back-to-back		
DB Double Arm Back-to-back		

DIMENSIONS

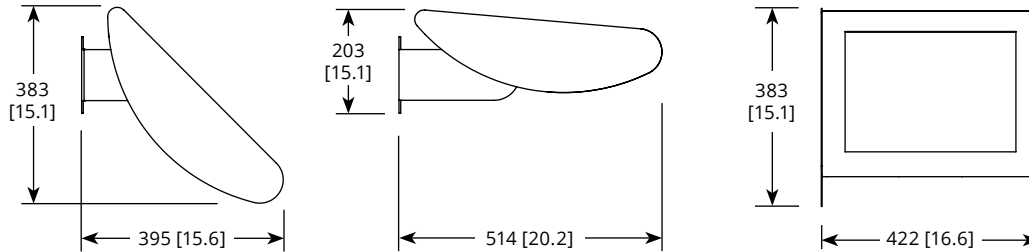

Pure Indirect Option

SPECIFICATIONS

Due to the Continuous Improvement Policy at Metalumen, we reserve the right to change our specifications without notice.

Housing: Fixture body is constructed using aluminum sheet, with 1.63mm (14 gauge aluminum sheet metal) nominal wall thickness.

Optical System: High flux, high efficacy, LED technology in conjunction with high efficiency reflectors and high transmittance lenses create controlled asymmetric distribution with comfortable low-glare illumination.

CRI: 80 minimum for all CCTs in standard configurations.

Lumen Maintenance: Reported L70 > 60,000 hrs at an ambient operating temperature of 35°C.

Finish: White paint with a coating suitable for natatoriums is standard. Custom natatorium finish also available.

Weight: See chart below.

Mounting: Standard hanger lengths are 2, 3, 4 and 5 ft. Consult factory for custom lengths. Pendant mounting is available with hangers in four options:

- single or double arm side-by-side
- single or double arm back-to-back
Wall mounting is available in two options:

- single wall mount
- double wall mount

Electrical: 120 V or 277 V/347 V prewired. Standard drivers feature electronic universal voltage (120-277V, 347 V/50-60 Hz), greater than 0.9 power factor, less than 20% harmonic distortion, and ambient temperature

range of 35°C (95°F) to minimum starting temp of -40°C (-40°F). Max amp draw @120V is 2.03Amps, @277V is 0.88Amps, @347V is 0.7Amps.

Approvals: This product is cULus listed. This product is not cULus listed when retrofitted.

Environment: Suitable for wet locations. IP65 rated.

NATA WEIGHTS

Fixture Type	Integral Fixture	Remote Fixture	Weight of brackets / hangers
Single Wall	6 kg [13.3lbs]	4 kg [8.8 lbs] (stand alone weight)	
Double Wall	16.8 kg [37.0 lbs]	12.8 kg [28.1 lbs]	4.8 kg [10.5 lbs]
Single Arm* (side-by-side, back-to-back)	12.8 kg [28.2lbs]	10.8 kg [23.7 lbs]	6.75 kg [14.9 lbs]
Double Arm* (side-by-side, back-to-back)	21.3kg [47.1 lbs]	17.3 kg [38.2 lbs]	9.3 kg [20.6 lbs]

*Max length 5 ft

WARRANTY

Metalumen will warrant defective luminaires for 5 years from date of purchase. Warranty is valid if luminaire is installed and used according to specification. If defective, Metalumen will send replacement boards or drivers at no cost along with detailed replacement instructions and instructions on how to return defective components to Metalumen.

REMOTE DRIVER BOX

Driver enclosures feature an **IP65 rating** and a **natatorium-grade finish**, providing complete protection against dust and low-pressure water jets. Laser-welded construction and a durable silicone gasket ensure a watertight seal, eliminating risk in pool environments. Enclosures can be mounted close to the luminaire, removing the need for a dedicated electrical closet.

Mounting location ideas:



To the ceiling or on support channels over the mounting brackets



Directly on the mounting arms

Remote Driver Mounting Maximum Wire Length

Due to the Continuous Improvement Policy at Metalumen, we reserve the right to change our specifications without notice.

Light Level	Drive Current (mA)	Wattage	Distance in feet / Wire Gauge					
			12 Ga.	14 Ga.	16 Ga.	18 Ga. (provided)	20 Ga.	22 Ga.
L1	2500	128	178	112	70	44	28	8
L2	4400	236	94	59	37	23	15	4
L3	3600 / 3600	470	84	53	33	21	13	4

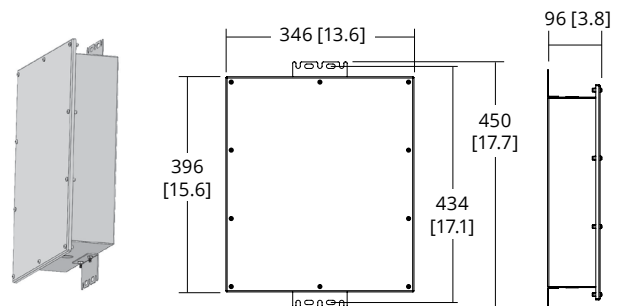

MOUNTING ARRANGEMENTS

SW - Single Wall

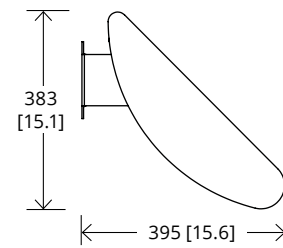
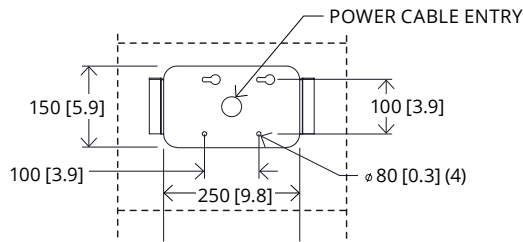

DW - Double Wall

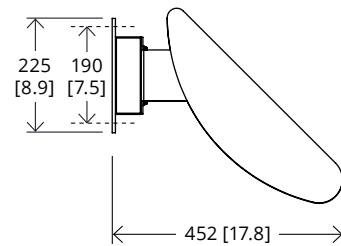
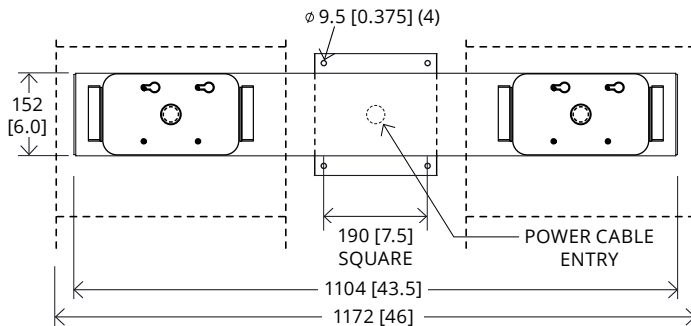

SA - Single Arm

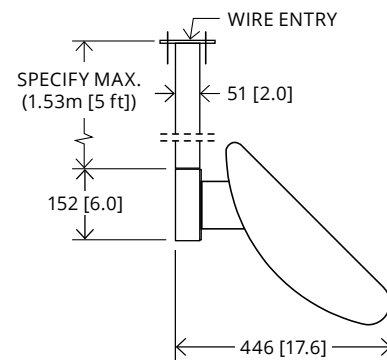
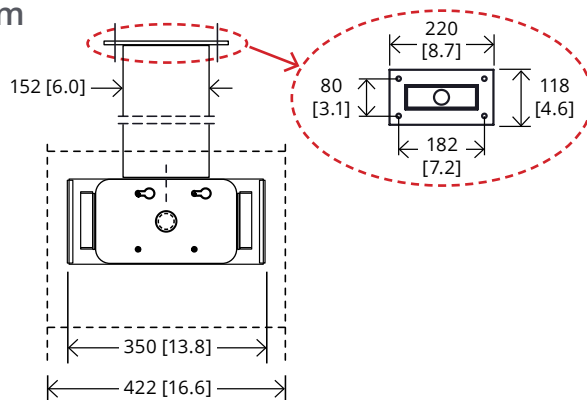

DA - Double Arm

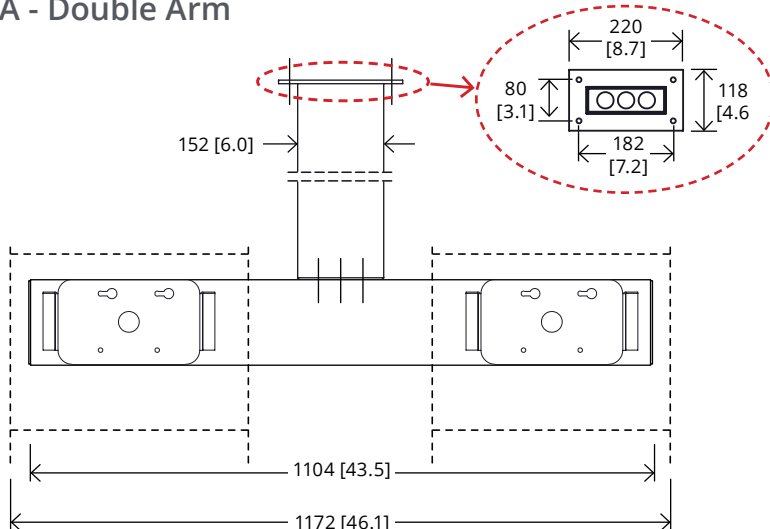

MOUNTING - MINIMUM DISTANCE FROM FLOOR

