



Barbican's FOM checks all the boxes for use in general lighting applications where performance, aesthetic, scale, design and budget are a concern. *2-Core LED technology* provides excellent low-glare performance by delivering soft and even illumination on walls, and work surfaces while providing subtle up lighting to avoid the 'cave effect' of direct only fixtures.

The **FOM** system allows for many configurations to fit any space you have. Using the FOM linear system is a cost effective alternative to traditional direct/indirect linear fixtures. Our multi-LED core on the direct side offers improved lateral light distribution for even horizontal light levels, as well as improved vertical illumination in a low glare and visually interesting form.



RELATED PRODUCT / ADAPTORS / ACCESSORIES

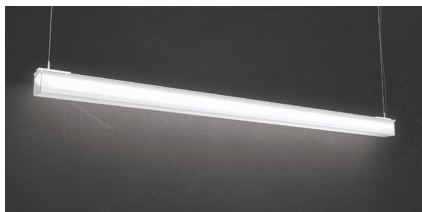

Single Pendant

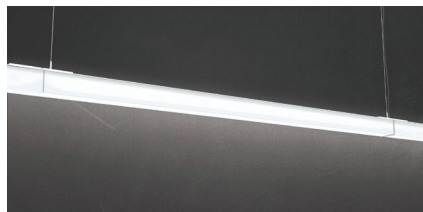

Linear Array - Flush Seam



Linear Array - Connector Block



L-Corner



T-Corner



X-Corner

AVAILABLE FINISH OPTIONS

Metal



SPECIFICATION (1/2)

Fixture	Width	Height	Length	Mounting	Driver Location
25-02					
25-02 FOM Diamond	8.5W 8.5"	3H 3"	12L 12"	ACM Aircraft Cable SFM Surface Mount* <i>Consult factory for surface mounting</i> * Requires "RD" Remote Driver option	SRDL Surface Rectangular Canopy
	12.5W 12.5"	4.6H 4.625"	24L 24"		SEDL Surface Rectangular Side Entry
			36L 36"		RADL Remote Acoustic Ceiling
			48L 48"		RHDL Remote Hard Ceiling
	CUSW Custom width <i>Consult factory</i>	CUSH Custom height <i>Consult factory</i>	CUSL Custom length to 120" in 1" increments. <i>Consult factory for oversized lengths</i>		ADDL ACT Remote Driver
					FCDL Flush Ceiling

Voltage	Canopy Finish	End Cap Finish	Ceiling Finishing Plate	Power Cable Finish	Color Temperature
UNV		WEC			
UNV 120/277 Volts <i>Consult factory for other voltages</i>	WCF White BCF Black	WEC White	NOFP None WFP White BFP Black	WPC White BPC Black	<div>White Sources</div> <div>2700K 2700K</div> <div>3000K 3000K</div> <div>3500K 3500K</div> <div>4000K 4000K</div> <div>3000FS Full Spectrum 3000K</div> <div>3500FS Full Spectrum 3500K</div> <div><i>Full spectrum .95 reduced output contact factory</i></div> <div>2765K Tunable White* 2700K - 6500K</div> <div>CUSK Custom CT*</div> <div>RGB / RGBW Sources</div> <div>RGBW RGBW*</div>

Color Rendering	Delivered Output	Options Continued on Next Page
90CRI		
90CRI 90+ CRI <i>Full Spectrum CRI is min 95+</i> <i>R1-R15 CRI min 90+</i>	<div>White Sources Static/Tunable</div> <div>0440LM Standard 440 lm/ft (4W/ft)</div> <div>0660LM Standard 660 lm/ft (6W/ft)</div> <div>0880LM Standard 880 lm/ft (8W/ft)</div> <div>1100LM Standard 1100 lm/ft (10W/ft)</div> <div>1320LM Standard 1320 lm/ft (12W/ft)</div> <div>1760LM Standard 1760 lm/ft (16W/ft)</div> <div>2200LM Standard 2200 lm/ft (20W/ft)</div> <div>CUSLM Custom Lumen Output* 200lm/ft - 2200lm/ft; Consult factory for outputs outside of this range</div> <div>RGB / RGBW Sources</div> <div>13WO Standard 13W/ft</div> <div><i>See page 3 for efficiency, W/ft and output details</i></div> <div><i>Separate indirect light option available. Consult factory for details.</i></div>	✓ ✓ ✓ ✓

SPECIFICATION (2/2)

Dimming Driver	Modular Configuration*	Configuration Adaptors*
<div></div> <div><p><i>White Sources Static</i></p><p>S010V10 Standard 0-10V, 10% S010V01 Standard 0-10V, 1%, (dim to off) EDALI01 DALI control, 0.1% LECO01 Lutron Ecosystem, 1% SOFTB, (Soft-on, Fade-to-Black)</p></div>	<div></div> <div><p><i>White Sources Tunable</i></p><p>TW010V Tunable White 2-Channel 0-10V TWDALI Tunable White DALI control LECOTW Lutron Ecosystem, 1%, Tunable White – T series</p><p><i>RGB / RGBW Sources</i></p><p>EDMX01 DMX, 0.1% CUSDD Other Driver Options <i>Consult factory for availability of other driver options (including POE and Camera Safe)</i></p></div>	<div></div> <div><p>NOMC MC No Configuration Configuration <i>Drawings Required.</i> <i>* See following pages for corners and configuration options</i></p><p>NOCA LPGCA No Adaptor Linear Purpose Gap LNGCA Linear No Gap 90LCA 90° L-Corner** 90TCA 90° T-Corner** 90XCA 90° X-Corner** CUSCA Custom Corner <i>Consult factory</i> <i>* Drawings Required</i> <i>Finishes match End Cap Finish</i> <i>** Quantity Required</i></p></div>

WRITTEN SPECIFICATIONS

<p>LED System</p> <ul style="list-style-type: none">LED Circuitry is applied to minimum 0.0625" thick aluminum extruded top plate for excellent heat management. Fixture uses Two-Core Technology to provide efficient, even illumination through 270 degrees.LEDs are 90+CRI, 3 SDCM.4 foot fixture performance at 3000K 90CRI, 6896lms, 61.44 Watts, 112 LPW Delivered <p>Construction</p> <ul style="list-style-type: none">Diffuser: 0.116" PETG (polyethylene terephthalate glycol-modified); which is a variant of PET used in water bottles everywhere. Designed to be used in environments where high levels of disinfectant products are used. It is also has a much higher impact resistance than Acrylic and is available up to 10 feet in single lengths.<ul style="list-style-type: none">Barbican uses a proprietary diffusion formula PETG which in conjunction with the LED system provides excellent efficiencies of up to 112 lumens per watt at 3000K 90+ CRI.Metal construction to be aluminum minimum 0.0625" thickness. Fasteners are to be stainless steel.Cable grippers are nickel plated solid brass and stainless steel. Cables are 1/16" stainless steel.Canopies and driver housings are minimum 0.0625" aluminum.	<p>Mounting</p> <ul style="list-style-type: none">Surface cable mounts are nickel plated solid brass and are supplied with escutcheon plates for through surface power cables. Power cables are low voltage from the canopy/remote mounted drivers.Drivers: All drivers are mounted remote from the fixture. Standard drivers include 0-10V 10% dimming 120/277V with Power Factor of >0.9. Barbican works with most Control and Driver manufacturers including POE and can easily modify the driver housings for special control gear. Fixtures over 96W may require more than one driver per fixture. Maximum standard length of lead is 12', longer lengths available, contact factory.Emergency fixtures are supplied with leads and KO for UL924 relays (by others). Battery back up will usually only drive one of two cores in larger fixtures to maintain the 90 minute requirement. Maximum distance driver to fixture 15 feet.Labels: ETL US and Canada, CE Europe and Middle East (Dry, Damp indoor use only)Finish: Polyester Powder Coated standard, Hand Brushed AluminumLumen Maintenance: Reported L90 > 10,000hrs, Calculated > 60,000hrs (TM-21)Warranty: 5 years limited at 25 Celsius. Contact Barbican for additional information. <p>Other</p> <ul style="list-style-type: none">Natatorium rating possible. Consult factor for details.
---	--

LABELS

 ETL/CE Listed

 Dry/Damp Rated

 5 Years 5-Year Warranty

 Power Over Ethernet

 Tunable White

 RGBW Color Tuning

 Full Spectrum

EXAMPLE LAYOUT (1/2)

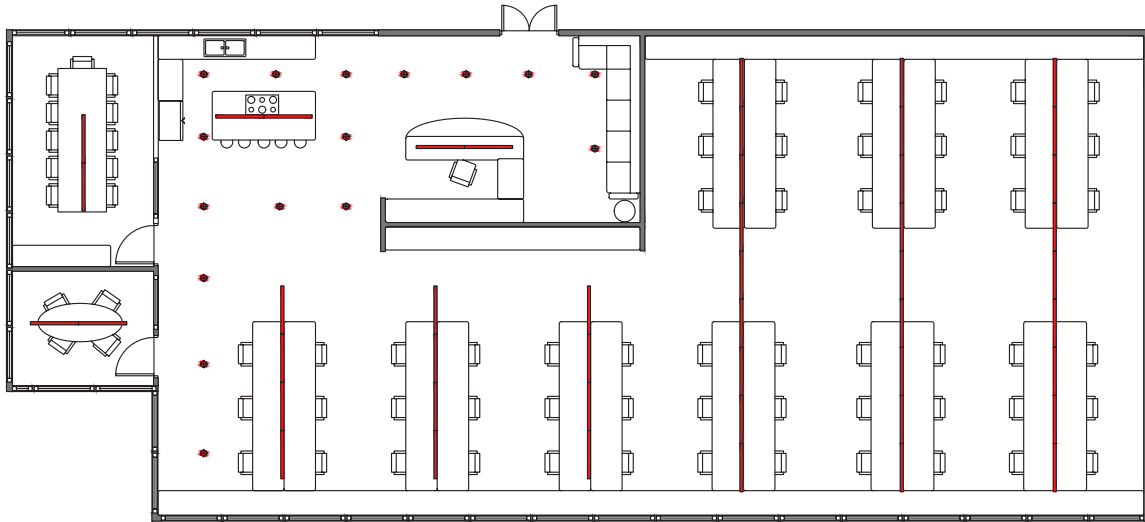

Mounting Height: 9'-0" AFF
Workplane Height: 2'-6" AFF
Suspension Length: 2'-0"
Spacing: 13'-0"
Fixture Specs: 3" x 3"
 660 lm/ft (6W/ft)
 3000K
Reflectances (%): 80/50/20
 Ceiling/Wall/Floor
UGR: <17
 CIE 190:2010

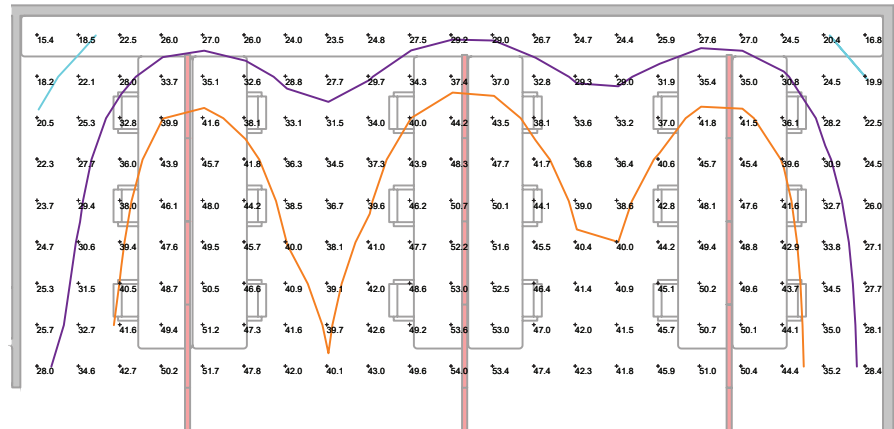
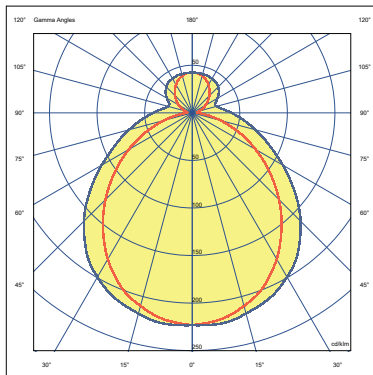
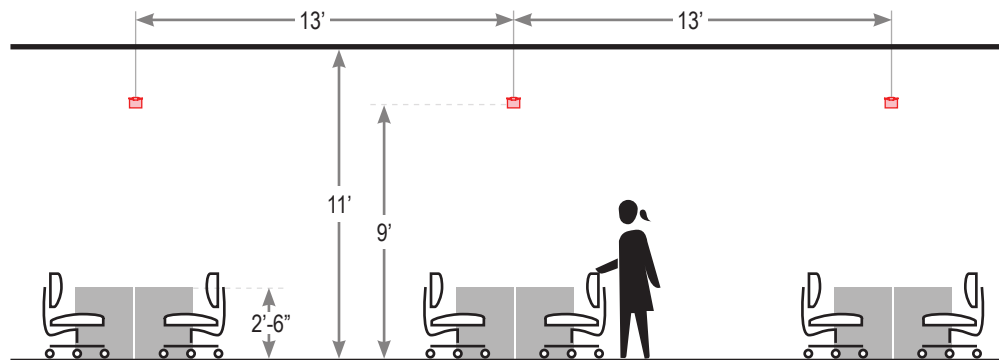

EXAMPLE LAYOUT (1/2)

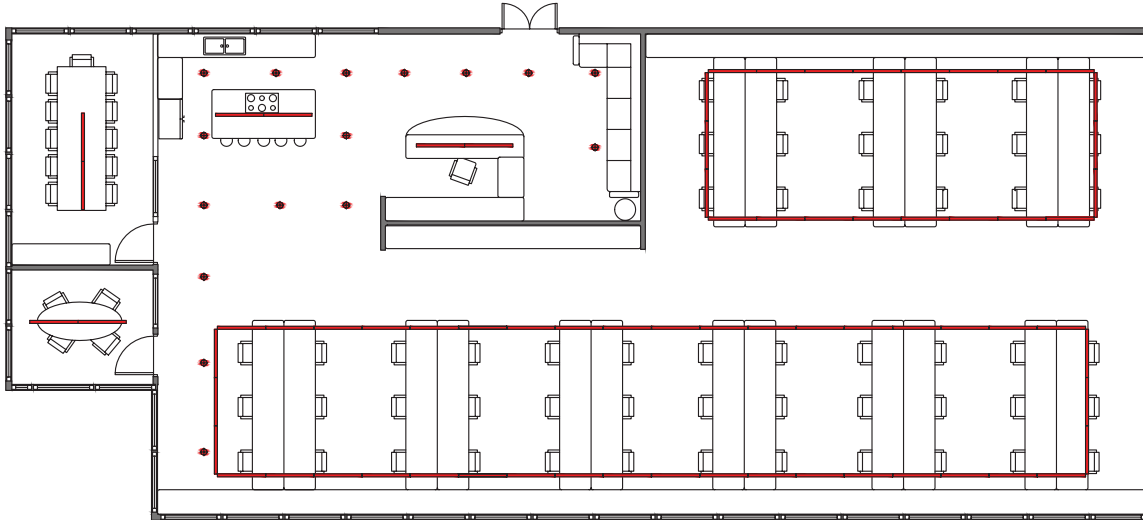

Mounting Height: **9'-0" AFF**
 Workplane Height: **2'-6" AFF**
 Suspension Length: **2'-0"**
 Spacing: **13'-0"**
 Fixture Specs: **3" x 3"**
660 lm/ft (6W/ft)
3000K
 Reflectances (%): **80/50/20**
 Ceiling/Wall/Floor
 UGR: **<17**
 CIE 190:2010

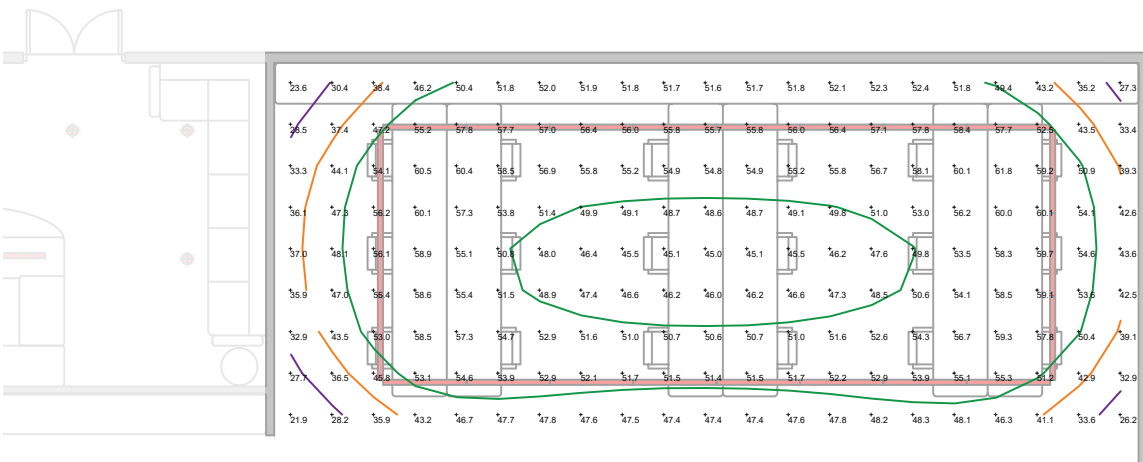
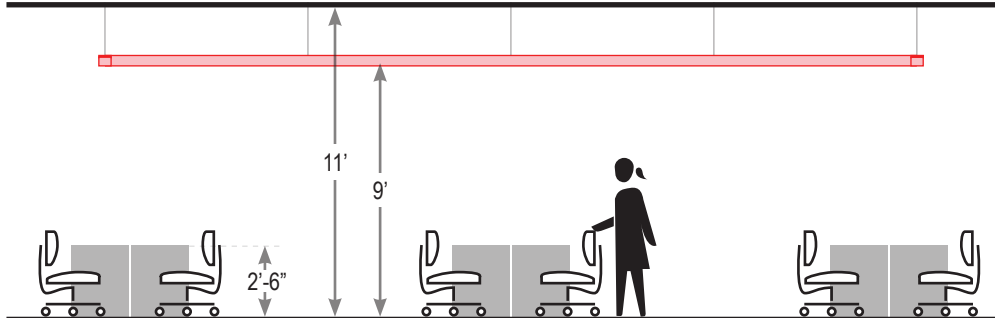

APPLICATIONS



FIXTURE CONFIGURATIONS

Standard Cross Sections

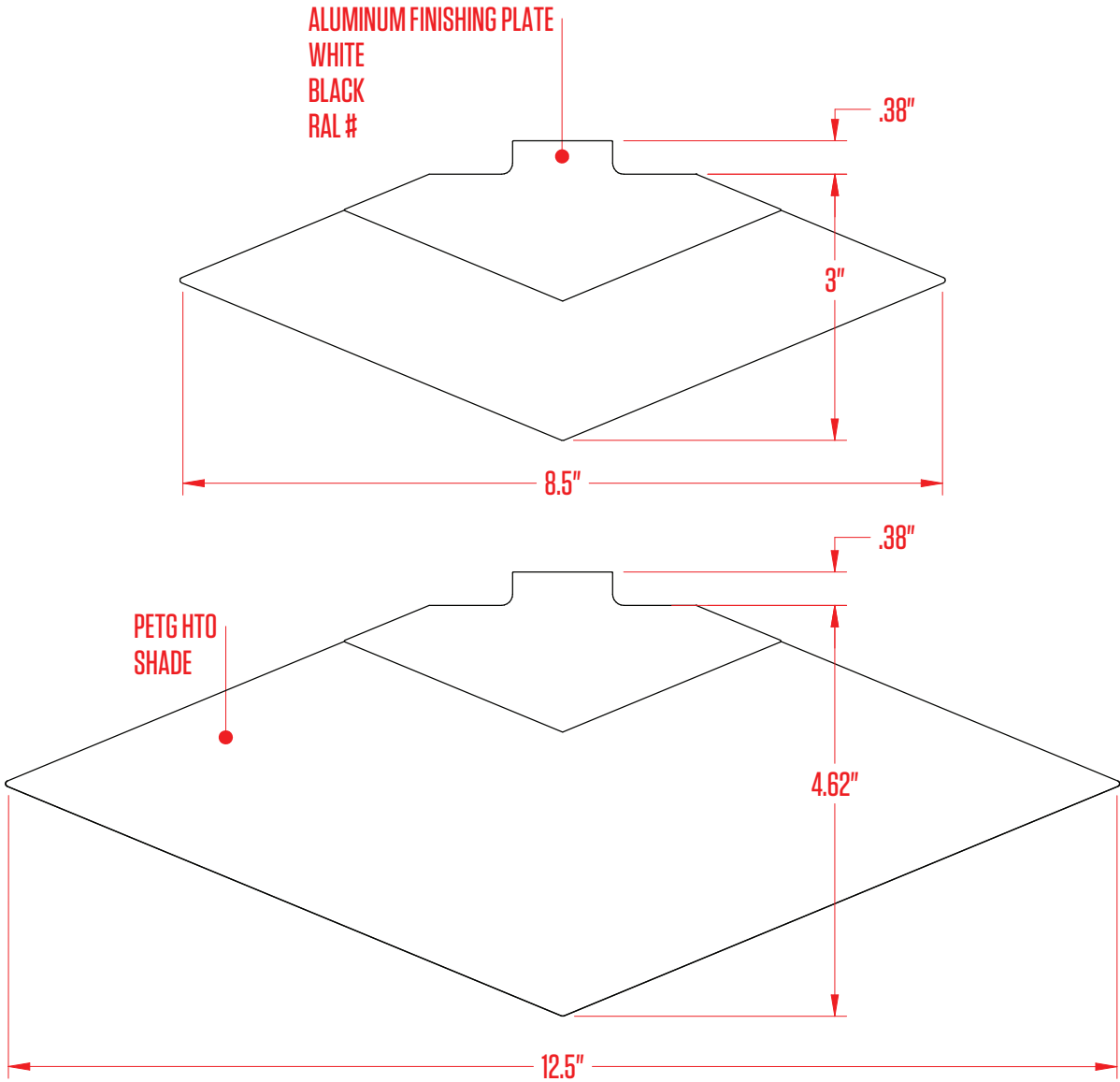

SPECIFICATION DETAILS (cont.)

Surface Rectangular Canopy
(SRDL)

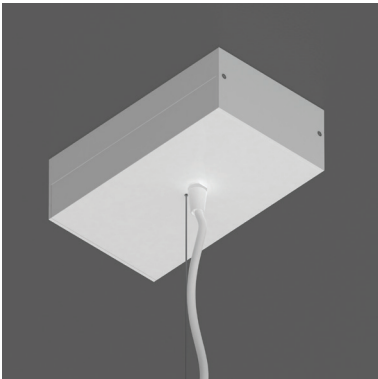

White Power Cord



Black Power Cord

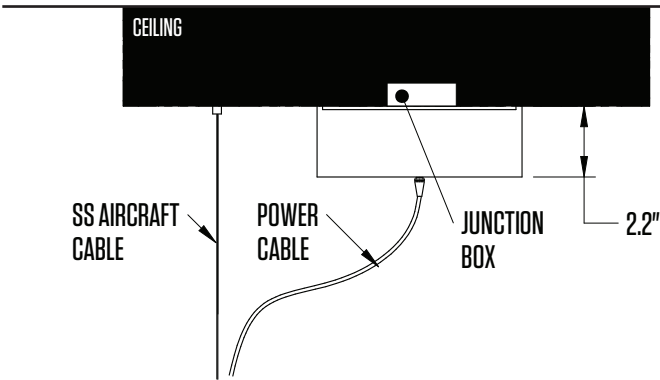
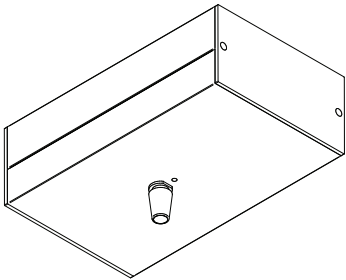

Offset Surface Ceiling Location Mounting Side View

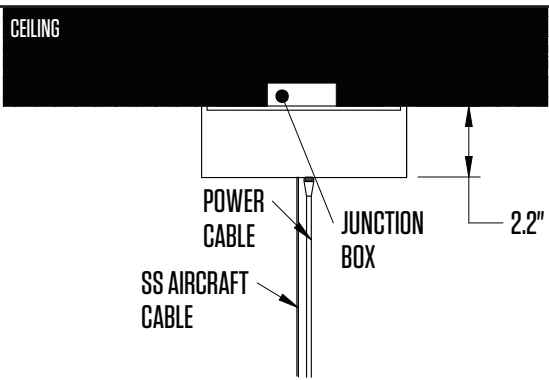

Surface Ceiling Location Mounting Side View

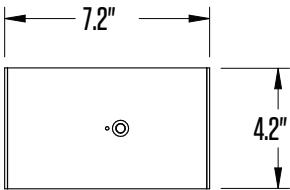

Surface Ceiling Location Mounting Bottom View

SPECIFICATION DETAILS (cont.)

Surface Rectangular Side Entry
(SEDL)

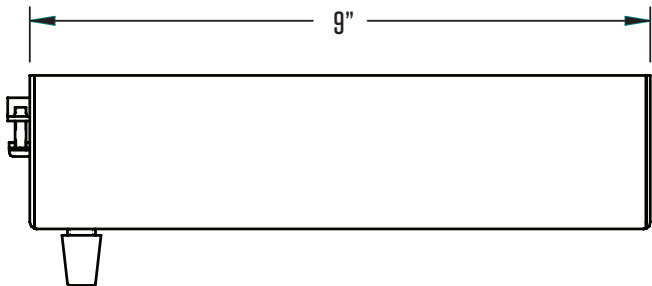
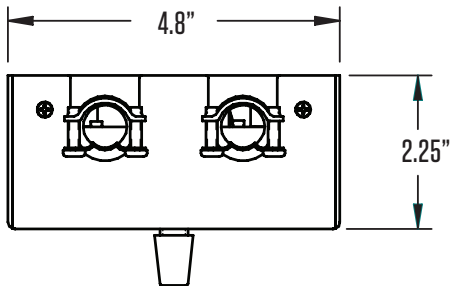
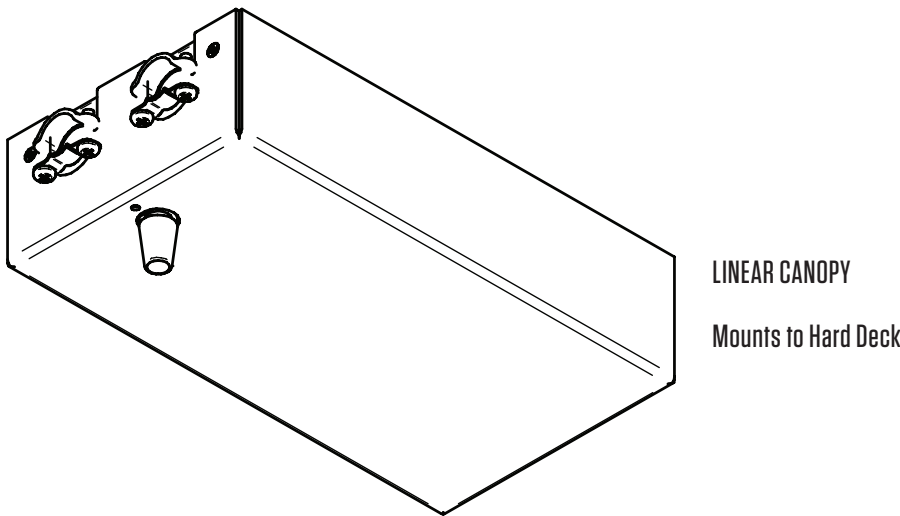

SPECIFICATION DETAILS (cont.)

**Remote Acoustic Ceiling Driver / Remote Hard Ceiling Driver
(RADL / RHDL)**

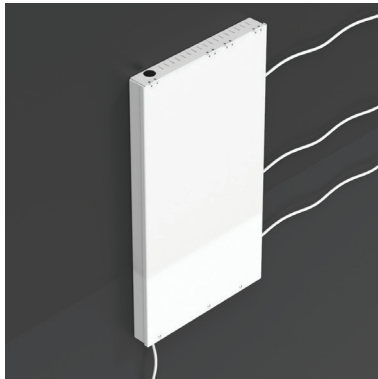

White Power Cord

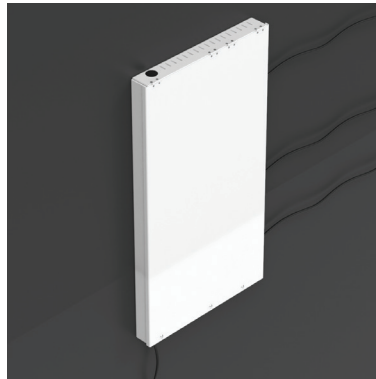

Black Power Cord

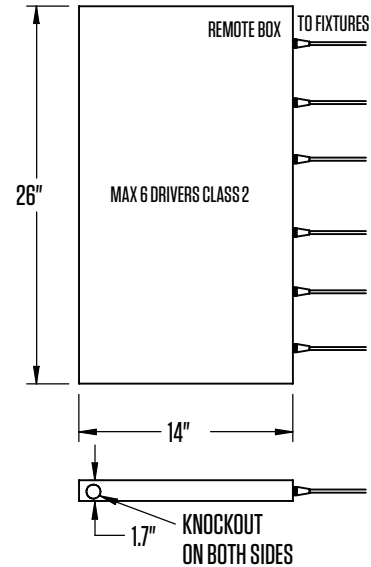

Acoustic Ceiling Power Supply Box Mounting Side View (RADL)

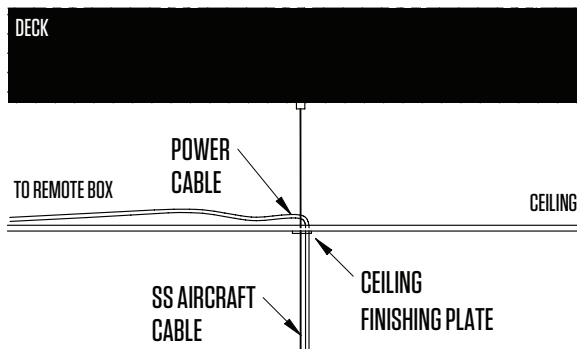

Ceiling Finishing Plate (FP) Optional

Solid Ceiling Power Supply Box Mounting Side View (RHDL)

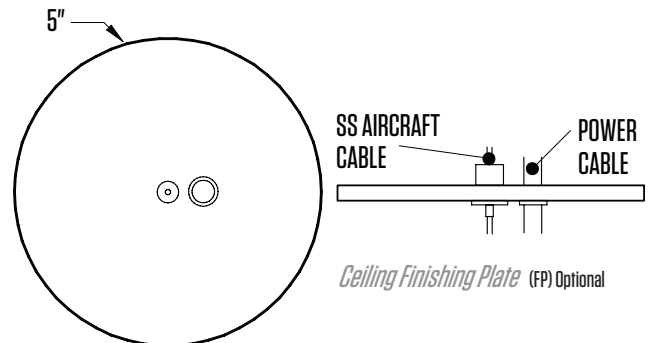
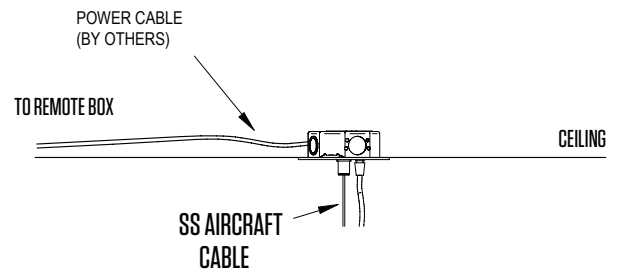

Ceiling Finishing Plate (FP) Optional

SPECIFICATION DETAILS (cont.)

**ACT Remote
Driver (ADDL)**

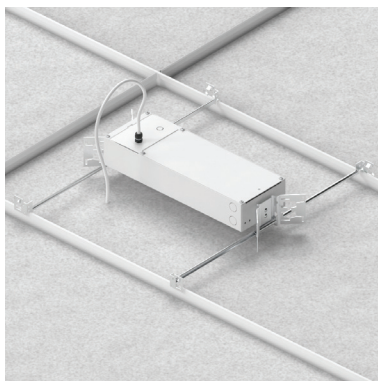

Driver Housing

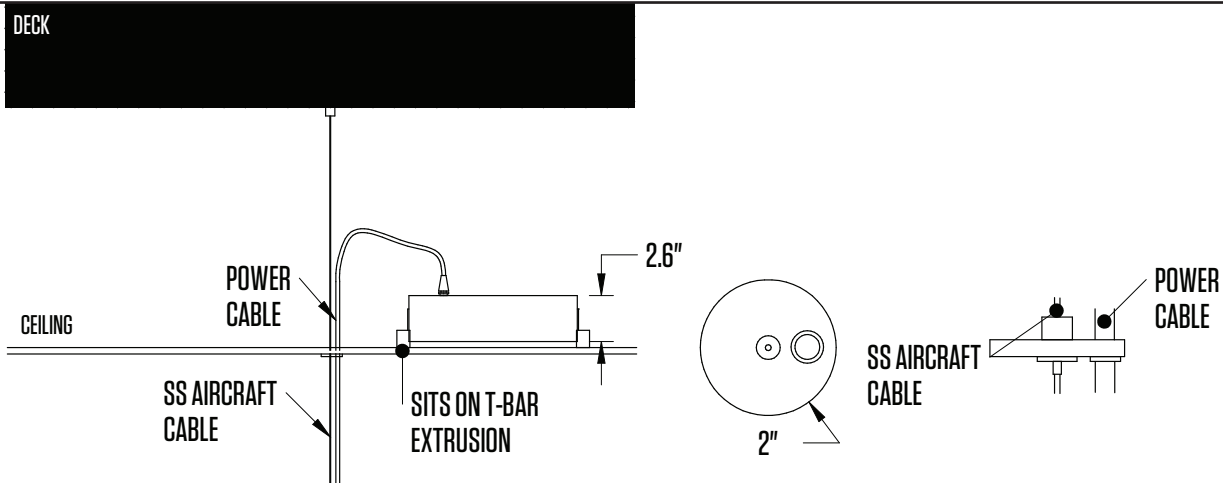
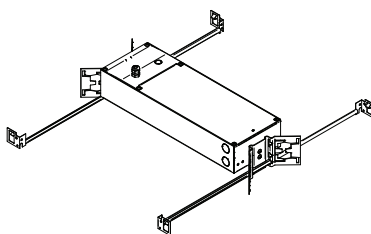

Above Ceiling Location Mounting Side View

Ceiling Finishing Plate (FP) Optional

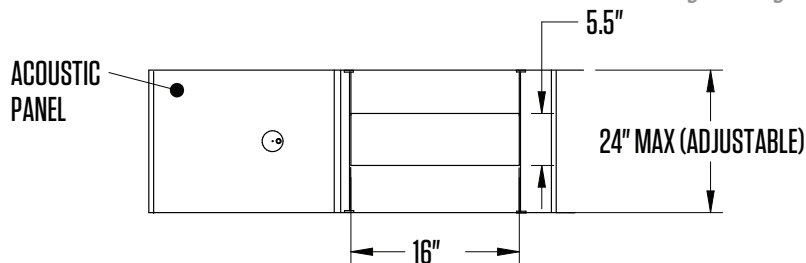

Above Ceiling Location Mounting Top View

SPECIFICATION DETAILS (cont.)

Flush Ceiling
(FCDL)



White Power Cord



Black Power Cord

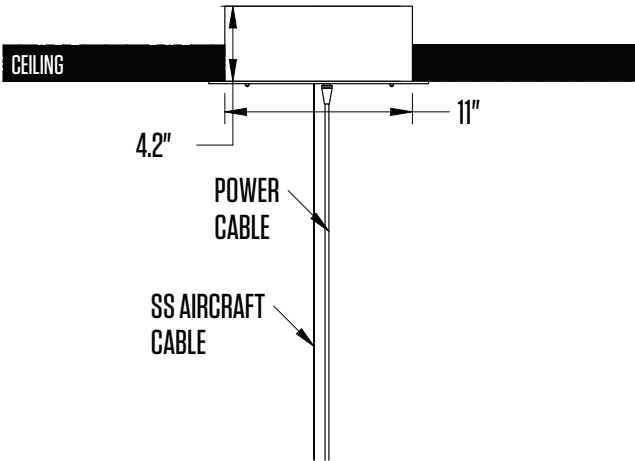

Flush Ceiling Location Mounting Side View

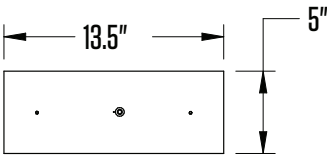

Flush Ceiling Location Mounting Bottom View