

Project Name _____

Qty _____

Type _____

Catalog / Part Number _____

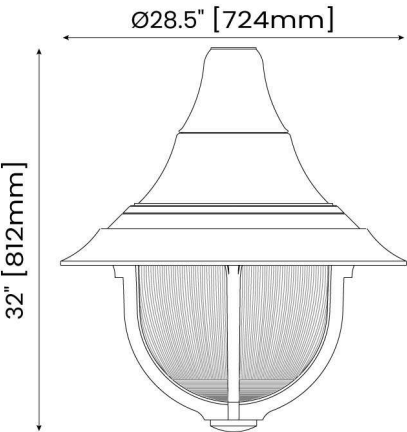

Distributions

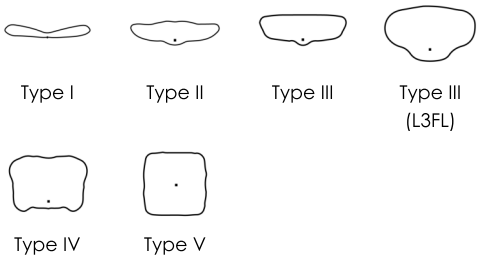

Description

The Concept family embodies ultimate versatility. With our vast collection of accessories, lenses, cages, and poles, you can seamlessly combine every component of a lighting fixture from top to bottom.

Whether for classic or contemporary settings, the diverse range of lighting solutions from the Concept family is ideal for any urban, suburban development. Select from over 100 unique models to bring your vision to life.

Smooth Finish

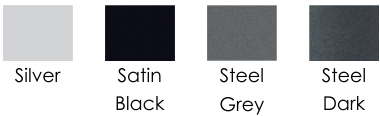

Textured Finish



Physical

Color Rendering Index	CRI 70, CRI 80
EPA	1.37 ft²
Weight	32.8 lb - 14.8 kg
Paint Finish	Silver, Steel Grey, Steel Dark, Satin Black, Mocha, Emerald, Ebony, Blue, Burgundy, Bronze, Green, Black, White, Custom color, Unknown/TBD, RAL Color
Surface Finish	Polyester powder coating, Complies with ASTM B117 standards, Minimum thickness of 100 microns, Complies with ASTM D2247 standards
Hardware material	Stainless steel hardware
Lens material	Acrylic DR lens: Lens made with an additive that offers strength similar to polycarbonate, without long-term yellowing.
Housing material	Made of crafted aluminium parts and extruded components., Minimum wall thickness of 0.188" [5 mm]

Features



Electrical and control

Voltage	120V, 208V, 240V, 277V, 347V, 480V
Control	0-10: 0-10V dimming, PRG: Programmable driver with custom dimming schedule, DBX: Manual Dimming Selector

Certifications



Driver	The device features a high-power factor of 90%. Can operate in ambient temperatures up to 130°F (55°C) with a Tcase-max of 194°F (90°C) It has a maximum total harmonic distortion of 20%. Includes a dimmable 0-10V driver. Suitable for both dry and damp locations and it also provides standard built-in surge protection for the driver, rated at a minimum of 3kV.
--------	---

Features

Distributions	L1: Type I L3: Type III L4: Type IV	L2B: Type II L3FL: Type III - Forward Throw L5: Type V
Color Temperature	1800K ¹ , 2200K ¹ , 2700K ¹ , 3000K, 3500K ¹ , 4000K	
Options	HSS: House side shield RCD-DOF: Internal DimOnOff light control system C/W antenna (software not included) PRG: Programmable driver with custom dimming schedule SGP-10: 10 KV Surge Protection SGP-10HV: 10 KV Surge Protection High Voltage SGP-20: 20 KV Surge Protection SGP-20HV: 20 KV Surge Protection High Voltage BTP: Button type photocell TRP: 7 Pin twist lock receptacle C/W Photocell ² TRP7: 7 Pin twist lock receptacle C/W Shorting CAP ² DBX: DIMBOX	
Warranty	10-year warranty (subject to certain conditions, see details).	

Environmental

Environment	Dry/damp/wet location
Operating Temperature	-40°C to 55°C [40°F to 131°F]

Notes

1. Consult factory
2. Only available with the EKF adaptor

DIMBOX (Option)

The DIMBOX is a numbered 10 step selector switch that allows for fine adjustment of the light levels in the field, repeatable from location to location. The enclosure is made of composite material, sealed to protect components for the life of the product.

As a standard, the DIMBOX will come factory installed on a bracket, wich could be installed in the luminaire or behind the pole door.



STEP DIMMING LEVELS			
Setting	Light level % (Reduction)	Setting	Light level % (Reduction)
10	100% (none)	5	75% (25%)
9	95% (5%)	4	70% (30%)
8	90% (10%)	3	50% (50%)
7	85 (15%)	2	45% (55%)
6	80% (20%)	1	25% (75%)

Others Options

TRP

7 pins twist lock photocell receptacle C/W photocell.

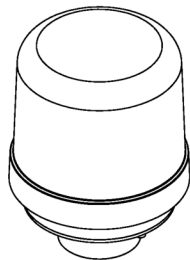

TRP7

7 pins twist lock photocell receptacle C/W shorting cap.

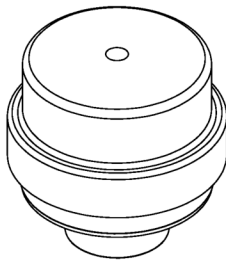

PER

Twist lock photocell receptacle only.



RCD-DOF

Remote controlled dimmer (Software not included).

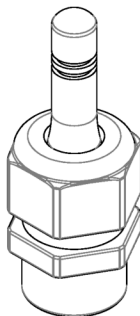

BTP

Button type photocell

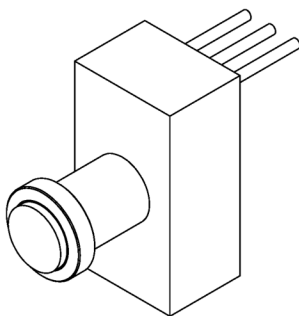

HSS

House side shield. (Directly mounted on optical lens)

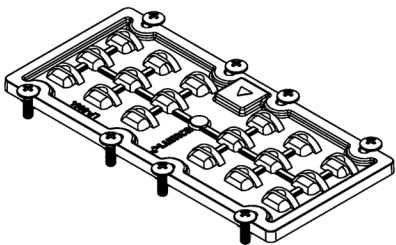

PRG

Programmable driver with custom dimming schedule

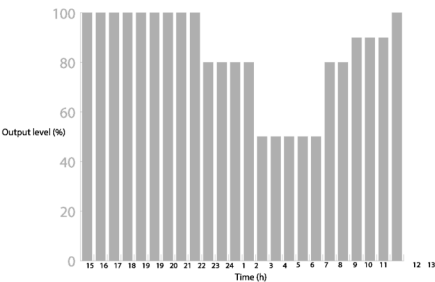

SGP-10 / SGP-10HV

10 KV Surge protection
Also available SGP-10HV (for Hight voltage, 347-480V)

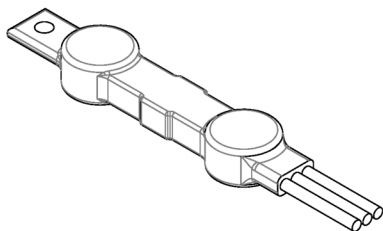

SGP-20 / SGP-20HV

20 KV Surge protection
Also available SGP-20HV (for Hight voltage, 347-480V)

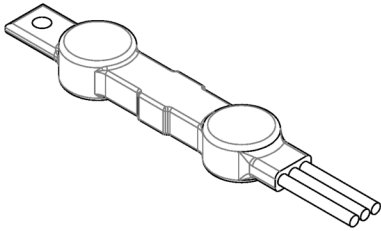

Tool-Less Access

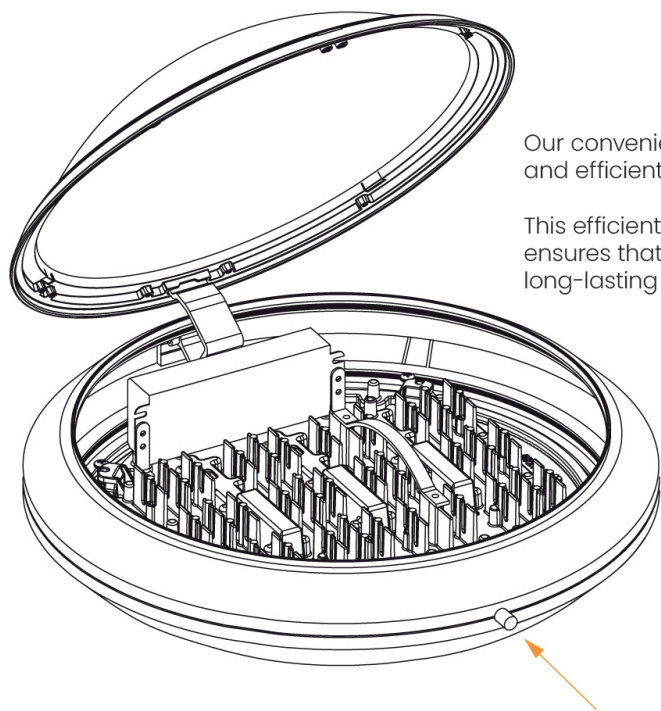

Our convenient push-button latch allows for quick and efficient driver access, making replacement and maintenance easy.

This efficient and user-friendly feature, combined with a weatherproof gasket, ensures that equipment remains in optimal condition, providing reliable, long-lasting performance with minimal effort and resources.

Adaptors

EKF
Adaptor

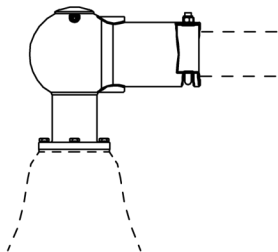

Pendant adaptor
for Ø2.375" (60mm)
horizontal arms

FIL
Adaptor

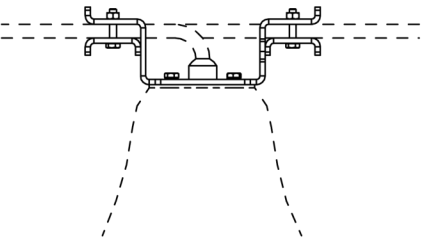

Catenary Wire
Adaptor

LED Current

Code	LED Current
LED01	175 mA
LED02	250 mA
LED03	350 mA
LED05	530 mA
LED07	700 mA

Source: I2LED05, the LED current is 530 mA.

How to Order

Product code	Adaptor	Source	Voltage	Distributions	Color Temperature	Color Rendering Index	Options	Paint Finish	RAL
CPL6105 CONCEPT	EKF Pendant adaptor for Ø 2.375 in horizontal arms FIL Catenary Wire Adaptor	12LED05 20W 2000 lumens	120 120V	L1 Type I	18K 1800K ⁽¹⁾	C70 CRI 70 C80 CRI 80	HSS House side shield	AGSM Silver	
		12LED07 27W 3000 lumens	208 208V	L2B Type II	22K 2200K ⁽¹⁾		RCD-DOF Internal DimOnOff light control system C/W antenna (software not included)	SGSM Steel Grey	
		18LED05 30W 3500 lumens	240 240V	L3 Type III	27K 2700K ⁽¹⁾		PRG Programmable driver with custom dimming schedule ⁽²⁾	SDSM Steel Dark	
		18LED07 40W 5000 lumens	277 277V	L3FL Type III (L3FL)	30K 3000K		SGP-10 10 KV Surge Protection	SBSM Satin Black	
		24LED05 40W 4500 lumens	347 347V	L4 Type IV	35K 3500K ⁽¹⁾		SGP-10HV 10 KV Surge Protection High Voltage	MCTXT Mocha	
		24LED07 54W 6000 lumens	480 480V	L5 Type V	40K 4000K		SGP-20 20 KV Surge Protection	ERTXT Emerald	
		36LED05 60W 7000 lumens					SGP-20HV 20 KV Surge Protection High Voltage	EBTXT Ebony	
		36LED07 80W 9000 lumens					BTP Button type photocell	BLTXT Blue	
		48LED05 80W 8500 lumens					TRP 7 Pin twist lock receptacle C/W Photocell ⁽³⁾	BGTXT Burgundy	
		48LED07 107W 9500 lumens					TRP7 7 Pin twist lock receptacle C/W Shorting CAP ⁽³⁾	BETXT Bronze	
		54LED05 90W 11 000 lumens					DBX DIMBOX	GNTXT Green	
		54LED07 120W 15 000 lumens						BKTXT Black	
		72LED05 120W 13 500 lumens						WHTXT White	
								SPC Custom color	
								COLOR Unknown/TBD	
								RAL RAL Color	

- Notes:
- 1. Consult factory
 - 2. Please ensure a photocell is selected (TRP, TRP7, PER or BTP) selection is mandatory.
 - 3. Only available with the EKF adaptor